

## PORTFOLIO

- Conception and creativity
- Development
- Verification of solutions | constructive details
- Pilot production | prototypes | zero series
- Validation
- Complete construction | documentation
- Certification, preparation and implementation
- Handing over to production
- Technology transfer

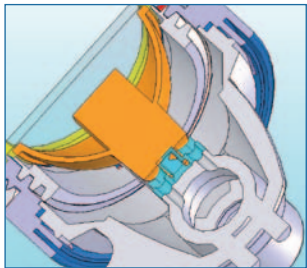

## AREAS

- Personal Care
- Lifestyle
- Lighting technology
- Connection assembly

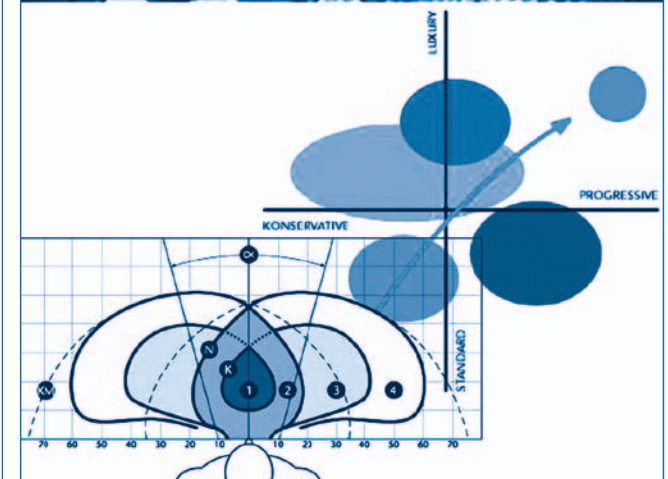
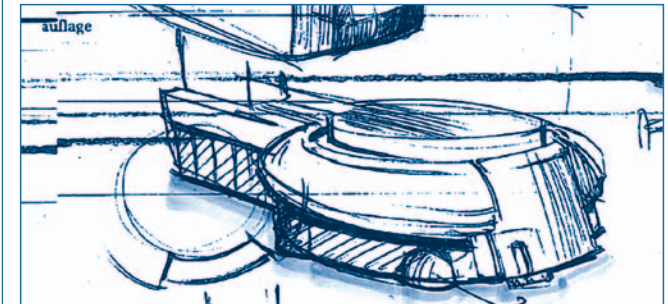
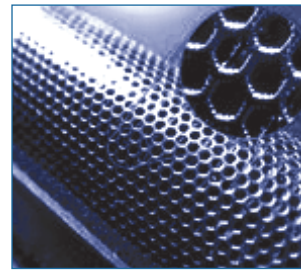
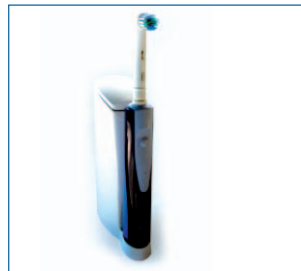

## EXPERIENCE & SERVICE

With up to 20 years of working experience and 150 projects brought in serial production we are able to help you in three different fields of duty:

### ::: A

- Simultaneous product design and engineering

### ::: B

- Engineering management, concept development for fine mechanic and injection moulding products and processes with characteristic assembly overpass und feasibility
- Value analysis for hidden potentials and technical improvements

### ::: C

- Interactive synergies of branches in product and process development
- (Re-) Concept development with focus on fine mechanic, mechatronic and injection moulding products

## ASSOCIATIVES

**bauer engineering**\*



## CPE GMBH

CEO | Dipl.-Ing. | Dipl. Wirt.-Ing.

**Achim Flessler**

Hanns-Martin-Schleyer-Str. 18a, Haus 3  
47877 Willich, Germany

Fon: +49 (2154) 953 658-0

Fax: +49 (2154) 953 658-30

Mobil: +49 (173) 566 26 68

[achim.flessler@cp-engineering.de](mailto:achim.flessler@cp-engineering.de)

[www.cp-engineering.de](http://www.cp-engineering.de)